



DC

LANE

SELL • LET • MANAGE

8 Ashley Place Arundel Crescent, Plymouth, PL1 5DZ

£115,000

 2

 1

 1

 D





£115,000

# 8 Ashley Place Arundel Crescent

Plymouth, PL1 5DZ

- OPEN DURING 2ND LOCKDOWN
- Ground Floor Maisonette
- No Onward Chain
- Double Glazing
- Courtyard Garden
- Two Double Bedrooms
- Off Street Parking Space
- Gas Central Heating
- EPC D

Located within walking distance of Plymouth Train Station, the life centre, Coach Station and the City Centre, this two double bedroom ground floor maisonette is ideally located for city life.

Briefly comprising of a lounge and kitchen diner to the ground floor, with two double bedrooms and a bathroom with shower over bath, to the lower ground floor. With private courtyard garden and off street parking space, offered to the market with no onward chain, this property really ticks all the boxes.

The maisonette holds a share of the freehold.



## Ground Floor

Lounge 14'3" x 12'8" (4.36 x 3.88)

Kitchen/Diner 11'4" x 11'8" (3.46 x 3.56)

## Lower Ground Floor

Bedroom One 14'3" x 12'8" (4.36 x 3.88)

Bedroom Two 10'9" x 8'6" (3.29 x 2.60)

Bathroom 7'5" x 5'6" (2.27 x 1.68)







## Directions

From our office: Head South on Mutley Plain, bearing Right onto North Hill. Turn Right onto North Road East. At the roundabout, take the Third exit onto Saltash Road. Turn Left onto North Road West and Right onto Arundel Crescent.









Floor Plans

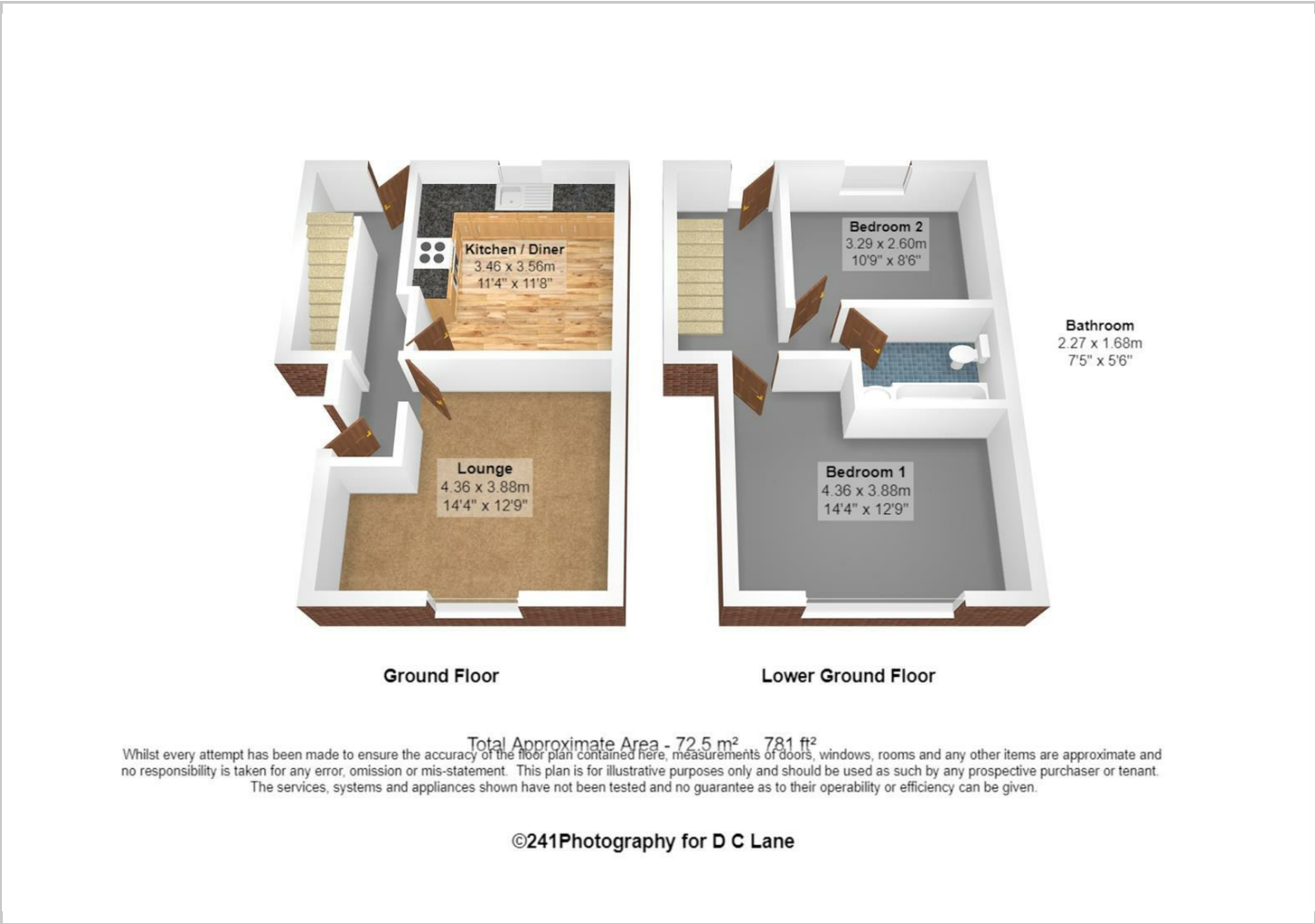

Viewing

Please contact our DC Lane, Plymouth Office on 01752 874242 if you wish to arrange a viewing appointment for this property or require further information.

The particulars are set out as a general outline only for the guidance of intended purchasers or lessees, and do not constitute, any part of a contract. Nothing in these particulars shall be deemed to be a statement that the property is in good structural condition or otherwise nor that any of the services, appliances, equipment or facilities are in good working order. Purchasers should satisfy themselves of this prior to purchasing.

Location Map



Energy Performance Graph

