



SELL • LET • MANAGE

13 May Terrace  
Plymouth, PL4 8PP

£130,000





## 13 May Terrace

St Judes, Plymouth, PL4 8PP

Attention First Time Buyers and Investors!

DC Lane bring to the market this lovely ground floor flat in popular St Judes, with excellent access into the city center and out to the A38.

The property benefits from 2 large double bedrooms, spacious living room with original marble fire surround and large bay to front, modern bathroom with 3 piece suite and well appointed kitchen with door to the private rear courtyard. Double glazing and gas heating compliment the well presented decor.

Offered Leasehold with 962 years remaining and currently let, the property offers a potential gross yield in excess of 6% and could be a great Buy to Let investment or first home.

- Ground Floor Flat
- Two Double Bedrooms
- Spacious Accommodation
- Beautifully Presented
- St Judes Location
- Rear Courtyard
- Gas Central Heating
- Double Glazing
- EPC Grade D
- Potential Investment or First Time Buy



Ground Floor

Living/Dining Room 15'2" x 7'4" (4.64 x 2.24)

Kitchen 13'1" x 9'6" (4.0 x 2.9)

Bedroom One 13'3" x 14'10" (4.04 x 4.54)

Bedroom Two 9'0" x 9'11" (2.76 x 3.04)

Bathroom 6'2" x 6'9" (1.9 x 2.08)







## Floor Plan

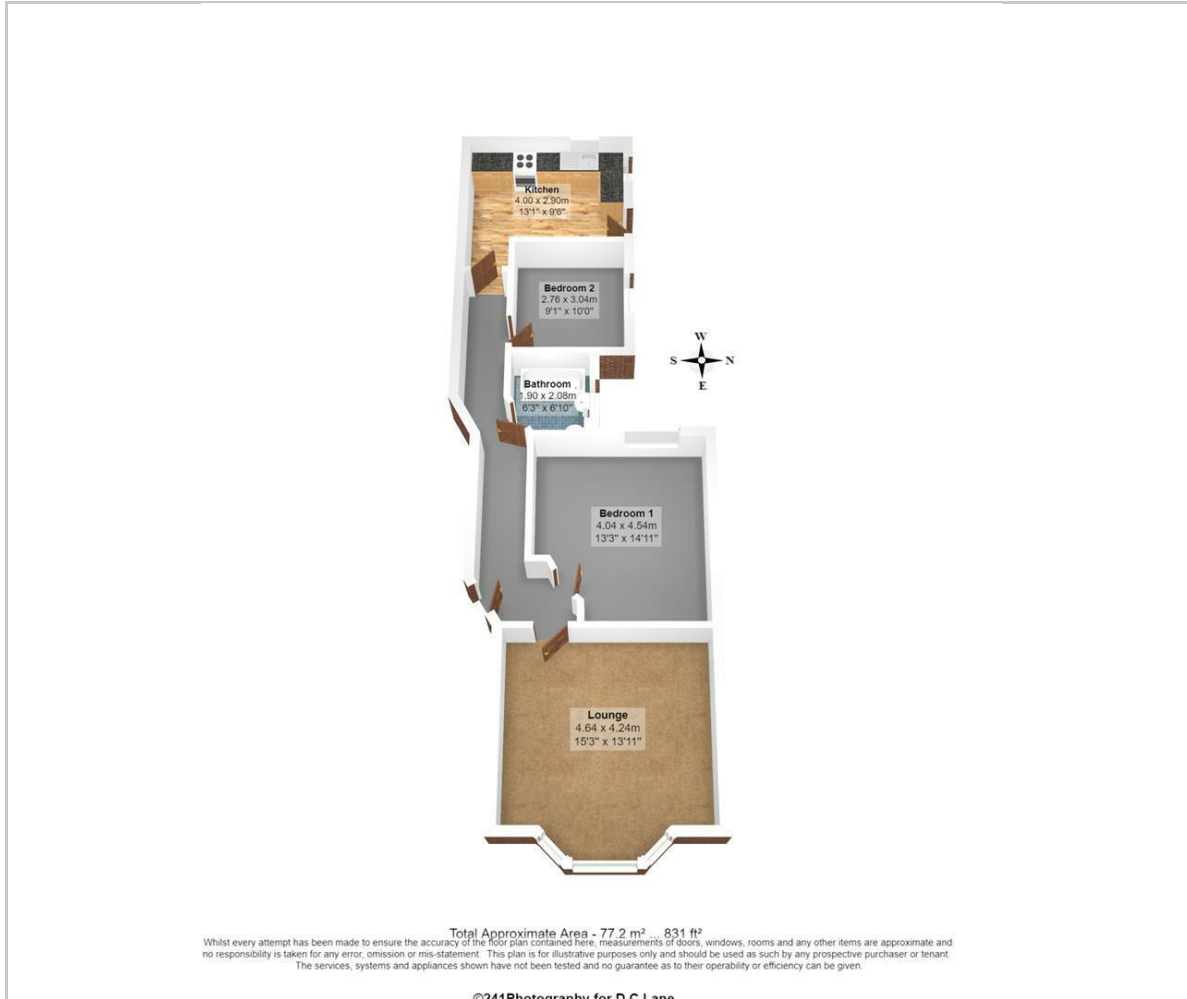

## Viewing

Please contact our DC Lane, Plymouth Office on 01752 874242 if you wish to arrange a viewing appointment for this property or require further information.

These particulars, whilst believed to be accurate are set out as a general outline only for guidance and do not constitute any part of an offer or contract. Intending purchasers should not rely on them as statements of representation of fact, but must satisfy themselves by inspection or otherwise as to their accuracy. No person in this firm's employment has the authority to make or give any representation or warranty in respect of the property.

**99 Mutley Plain, Mutley, Plymouth, Devon, PL4 6JJ**  
01752 874242 | hello@dclane.co.uk | www.dclane.co.uk

## Area Map



## Energy Efficiency Graph

